

# Installation Guide

Picture 1



Parts List: as the picture shows.

Picture 2

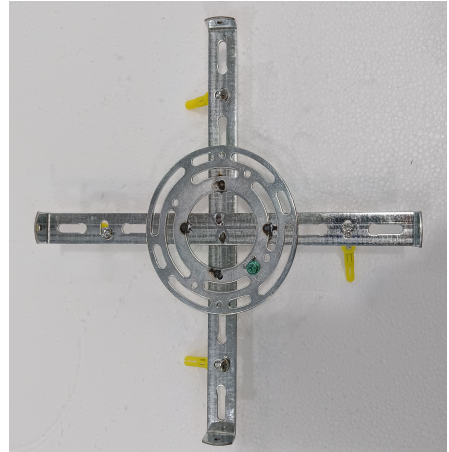

Step 1: Unscrew the inner panel of the chassis and fix it to the wall.

Picture 3

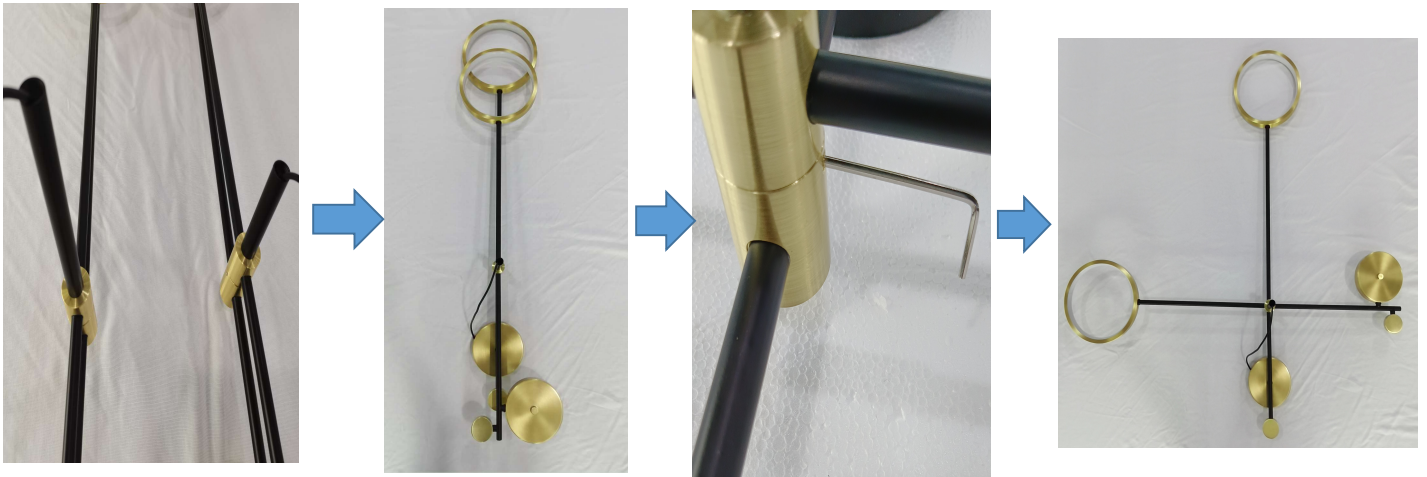

Step 2: Tighten the two light poles separately according to the picture, loosen the screws to adjust the shape of the lamp body, and re-tighten the screws to fix it.

Picture 4

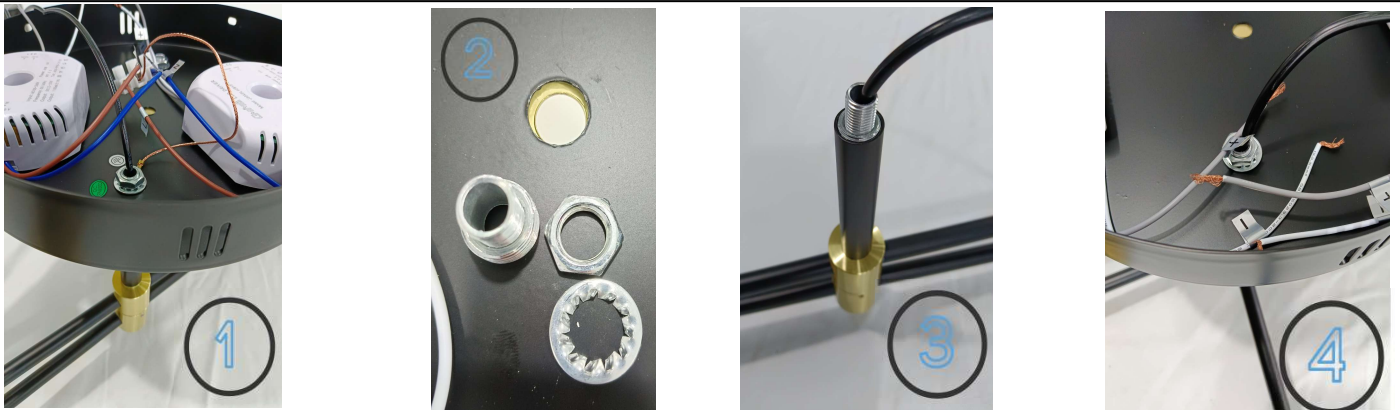

Step 3: Install the short light pole and screw the short light pole to the screw with the ground wire (as shown in Figure 1); Install the long light pole, unscrew the nut on the end without the ground wire, and install the screw on the long light pole. And screw the light body with the long light pole to the chassis.(as shown in Figure 123)

Picture 5

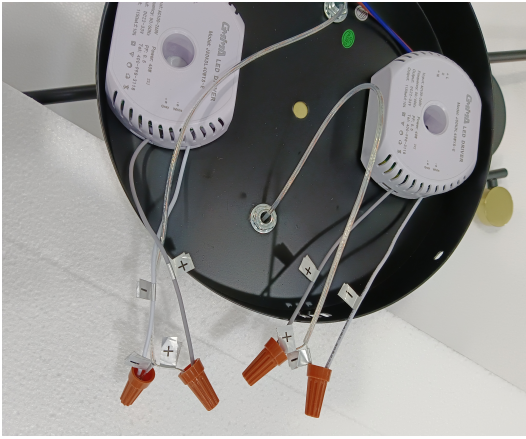

**Step 4:**Distinguish the positive and negative wiring according to the diagram. (one driver is connected to one lamp body)

Picture 6

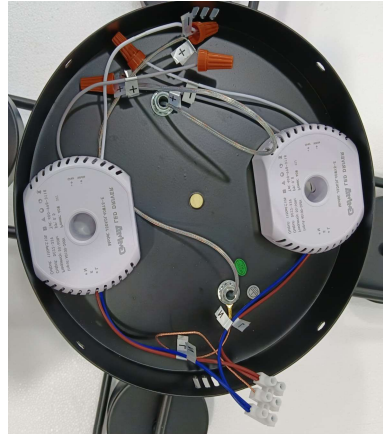

**Step 5:**Connect the power wire to the terminal. (the red wire is L, the blue wire is N)

Picture 7



**Step 6:**Fasten the chassis to the pegboard.

Picture 8

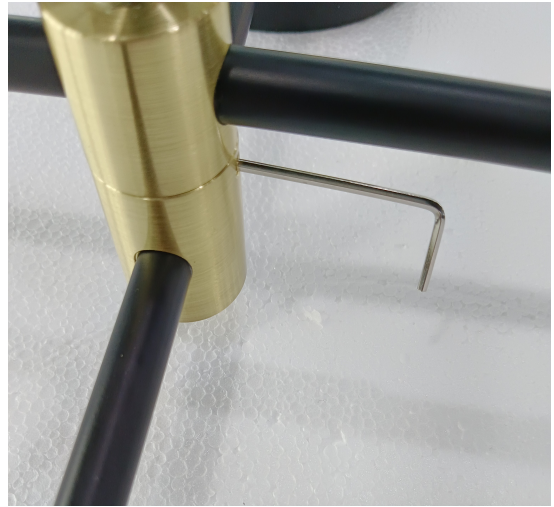

**Step 7:**Repeat the second step to adjust the lamp body to the shape you like.

Picture 9



**Completion.**