



ANTI-TIP RESTRAINT INSTALLATION

! A WARNING!

Serious or fatal crushing injuries can occur from furniture tip-over. To help prevent tip-over:

- Install tip-over restraint provided.
- Do not set heavy objects on top of this product, unless the product is specifically designed to accommodate them.
- Never allow children to climb or hang on mirrors, shelves, consoles, or cabinets with doors and/or drawers.

The use of tip-over restraints may only reduce but not eliminate, the risk of tip-over.



REQUIRED TOOL
8MM / 5/16" DRILL BIT

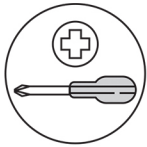

REQUIRED TOOL

Choose the proper installation option based on your product purchased.

Option 1 Installation Steps



- It is suitable for smooth and flat walls such as tiles and glass. Not suitable for uneven walls.

PARTS INVENTORY	
DESCRIPTION	QTY
NAIL-FREE SCREW STICKERS 	2

Step 1: Clean the wall.

Step 2: Peel off the protective film of nail-free screw stickers.

Step 3: Through the holes inner the cabinet, hang the cabinet on the nail-free screw stickers, and then let it stand for 12 hours.

Option 2 Installation Steps

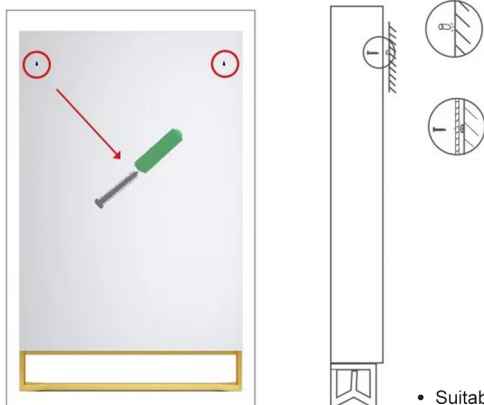

PARTS INVENTORY	
DESCRIPTION	QTY
NUT 	2
PLUG 	2
SCREW 	2

- Suitable for latex paint wall/diatom mud wall.

Step 1. Mark on the wall where the screws should be placed, then drill holes and insert the plugs into the drilled holes.

Step 2. Insert the metal nuts and screws through the holes inner the cabinet, then tighten the screws.