

Installation Guide

Picture 1



Parts List: as the picture shows.

Picture 2

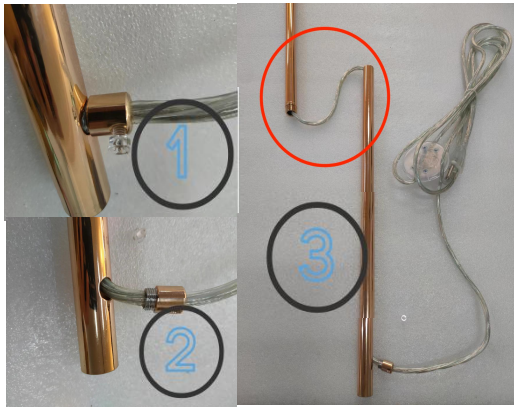

Step 1: First unscrew the locking wire buckle, and pull out the wire in the light pole.

Picture 3



Step 2: After installing the light pole, tighten the screws.

Picture 4

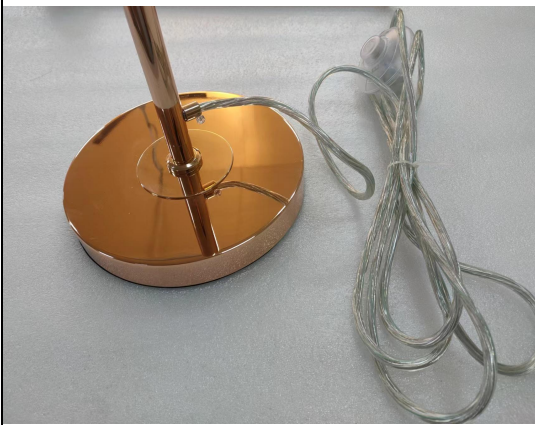

Step 3: Install the base.

Picture 5



Step 4: Install Feather + Light Source.

Picture 6



Completion.